

That the Sub-Committee provides the reasons for its decision

## 2 REPORT

### 2.1 Human Rights Act Appraisal

The Committee is required to consider the consequences of refusal or approval on the applicant's human rights.

### 2.2 Financial Implications

None.

## 3. Background

### 3.1 Anil Gocen has made an application for a new Premises Licence, the requested licensable activities and opening hours are:

#### Regulated Entertainment: Live Music & Recorded Music

Sunday to Thursday	1800 to 0000 hours
Friday	1800 to 0130 hours
Saturday	1800 to 0200 hours

#### Late Night Refreshment

Sunday to Thursday	2300 to 0000 hours
Friday	2300 to 0130 hours
Saturday	2300 to 0200 hours

#### Supply of Alcohol

Sunday to Thursday	1000 to 0000 hours
Friday	1000 to 0130 hours
Saturday	1000 to 0200 hours

#### For the consumption ON the premises

#### Hours Open to Public:

Sunday to Thursday	0900 to 0100 hours
Friday	2300 to 0230 hours

### 3.2 For a new application, applicants are required to submit an operating schedule detailing how they intend to promote the four licensing objectives, these are the prevention of crime and disorder, promotion of public safety, the prevention of public nuisance and the protection of children from harm. The applicant has indicated a number of model conditions that he feels can be imposed on any granted licence. See Appendix 1 –Operating schedule General:

### 3.3 Prevention of Crime and Disorder

### 3.4 Public Safety

### 3.5 Prevention of Public Nuisance

### 3.6 Protection of Children from Harm

4. Objections Received (Responsible Authorities)

- 4.1 Objections were received from the Responsible Authorities, namely the Police and EHO Noise Officer and the Licensing Authority.  
Appendix 2

5. Objections received (Other Persons)

- 5.1 Letters of representations have been received from other persons, who have concerns principally in respect of public nuisance and public safety. Those concerns relate to the nuisance that will be caused to local residents if a licence was to be granted to the lateness of the hours applied for, and speak of nuisance that has been experienced by residents as a result of past and current operation of the venue.  
Residents representations Appendix 3

- 5.2 The premises has been operated as a public house for many years but applied to have regulated entertainment added to the licence in 2011. The application did receive objections but extensive conditions were added to the licence and granted by the LSC. The premises became a source of complaints relating to noise nuisance and crime and disorder on the street outside from patrons and those associated with the venue.

- 5.3 The ongoing issues lead to a resident applying for a review of the premises licence in Late September 2016 which was heard by the LSC in December 2016. The Committee took into consideration the record of incidents relating to public nuisance and crime and disorder as submitted by local residents, the Council's Noise Enforcement team and the Police. The committee was satisfied that despite having had a number of opportunities to address the public nuisance and crime and disorder that were emanating from the premises, the management of the premises had failed to take adequate steps to address the behaviour concerned. The evidence put forward regarding the incidents by the applicant and his representative was credible and reflected long standing matters of concern to residents. It was also clear that the impact and potential harm to local residents, many of whom are vulnerable by reason of age could not be ignored. The committee took the view that the measures imposed were an appropriate and proportionate response to promote the four Licensing Objectives.

The LSC determined the following:

Opening hours were reduced to:

Monday to Sunday: 1000 to 0000

Supply of alcohol:

Monday to Sunday: 1000 to 2330

Live music and recorded music:

Monday to Sunday: 1000 to 2330

Provision of late night refreshment:

Monday to Sunday: 2300 to 2330

The outside shisha area is to close and all customers are to be asked to come inside by 2230, Monday to Sunday. A copy of the current licence is shown at Appendix 4.

5.4 The current applicant is seeking the ability to operate the premises until 2/4 am respectively. The Home Office Guidance issued under Section 182 Guidance places a requirement on applicants to demonstrate when setting out steps they propose to take to promote the licensing objectives that they understand the area in which they are wishing to operate.

5.5 Mr Gocen attempted a previous application in May 2017 but the matter had to be declared void at the LSC hearing due to the plans submitted not properly reflecting the layout of the premises.

## 6 Options for Consideration

6.1 The options available to the Licensing Sub-Committee having considered all the relevant information are as follows:

- To refuse to grant the licence
- To grant the licence with conditions
- To grant the licence but restrict the licensable activities
- To grant the licence with restricted times

6.2 Additional conditions or restrictions to licensable activities and/or times should only be imposed if considered appropriate for the promotion of the licensing objectives. If other law already places certain statutory responsibilities on a premises, it would not be appropriate to impose similar duties.

6.4 Members of the Sub-Committee should be advised that the applicant or any

other person who made relevant representations in relation to the application may appeal against the decision made to the Magistrates' Court within 21 days of the date on which they were notified.

## 7. Standard of Decision Making

7.1 In accordance with the provisions of the Licensing Act 2003 and the Council's scheme of delegation, all applications where a relevant representation has been made need to be determined by this Sub-Committee.

7.2 When determining the application, the Sub-Committee should only consider issues, which relate to the four licensing objectives. The licensing objectives are:

- The prevention of Crime and Disorder
- Public Safety
- The prevention of a Public Nuisance
- The protection of Children from Harm

7.3 Members of the Sub-Committee must have regard to the statutory guidance issued under section 182 of the Licensing Act 2003 and the Council's Statement of Licensing Policy. Members of the Sub-Committee may deviate from the statutory guidance and licensing policy only if they deem that there is good reason to do so.

7.4 Members of the Sub-Committee should not allow themselves to predetermine the application or to be prejudiced in favour or opposed to the licence and shall only determine the application having had an opportunity to consider all relevant facts.

## 8 Licensing Policy

The committee will also wish to be aware of the guidance issued under section 182 of the Licensing Act 2003. Licensing is about regulating the provision of licensable activities on licensed premises, by qualifying clubs and at temporary events within the terms of the Licensing Act 2003. The terms and conditions attached to various permissions are focused on matters which are within the control of individual licensees and others granted relevant permissions. Accordingly, these matters will centre on the premises and places being used for licensable activities and the vicinity of those premises and places.

The objective of the licensing process is to allow for the carrying on of retail sales of alcohol and the prevention of public nuisance, prevention of crime and disorder, public safety and protection of children from harm. It is the Licensing Authority's wish to facilitate well run and managed premises with licence holders displaying sensitivity to the impact of the premises on local residents.

Where relevant representations are made, this authority will demand stricter conditions with regard to noise control in areas that have denser residential accommodation, but this will not limit opening hours without regard for the individual merits of any application. This authority will consider each application and work with the parties concerned to ensure that adequate noise control measures are in place.

#### 8.1 Licensing hours

Where relevant representations are made, the Council will consider the proposed hours on their individual merits. Notwithstanding this, the Council may require stricter conditions in areas that have denser residential accommodation to prevent public nuisance. The Council will endeavour to work with all parties concerned in such instances to ensure that adequate conditions are in place. The Council may restrict the hours that certain premises can offer alcohol for sale for consumption off the premises for preventing crime, disorder and nuisance.

#### 4. Other considerations

Section 17 of the Crime and Disorder Act 1998 states:

"Without prejudice to any other obligation imposed on it, it shall be the duty of each authority to which this section applies to exercise its various functions with due regard to the likely effect of the exercise of those function on, and the need to do all that it reasonably can to prevent crime and disorder in its area".

#### 5 Use of Appendices

Appendix 1 – Application and plan

Appendix 2 – Letters of representation-RAs

Appendix 3 – Letters of representation –Residents

Appendix 4- copy of current licence

Background papers: Section 82 Guidance

Haringey Statement of Licensing policy

**Appendix 1- Application and Plan**

# Haringey

LONDON COUNCIL  
LICENSING  
RECEIVED  
- 7 AUG 2017  
NK/389510

Application for a premises licence to be granted  
under the Licensing Act 2003

PLEASE READ THE FOLLOWING INSTRUCTIONS FIRST

Before completing this form please read the guidance notes at the end of the form. If you are completing this form by hand please write legibly in block capitals. In all cases ensure that your answers are inside the boxes and written in black ink. Use additional sheets if necessary.

You may wish to keep a copy of the completed form for your records.

I/We ANIL GOGEN  
*(Insert name(s) of applicant)*

apply for a premises licence under section 17 of the Licensing Act 2003 for the premises described in Part 1 below (the premises) and I/we are making this application to you as the relevant licensing authority in accordance with section 12 of the Licensing Act 2003

Part 1 - Premises details

Postal address of premises or, if none, ordnance survey map reference or description			
83 MAYES ROAD			
Post town	WOOD GREEN	Postcode	N22 6WP

Telephone number at premises (if any)	
Non-domestic rateable value of premises	£18,000

Part 2 - Applicant details

Please state whether you are applying for a premises licence as Please tick as appropriate

- a) an individual or individuals \*  please complete section (A)
- b) a person other than an individual \*
  - i as a limited company/limited liability partnership  please complete section (B)
  - ii as a partnership (other than limited liability)  please complete section (B)
  - iii as an unincorporated association or  please complete section (B)
  - iv other (for example a statutory corporation)  please complete section (B)
- c) a recognised club  please complete section (B)
- d) a charity  please complete section (B)

- e) the proprietor of an educational establishment  please complete section (B)
- f) a health service body  please complete section (B)
- g) a person who is registered under Part 2 of the Care Standards Act 2000 (c14) in respect of an independent hospital in Wales  please complete section (B)
- ga) a person who is registered under Chapter 2 of Part 1 of the Health and Social Care Act 2008 (within the meaning of that Part) in an independent hospital in England  please complete section (B)
- h) the chief officer of police of a police force in England and Wales  please complete section (B)

\* If you are applying as a person described in (a) or (b) please confirm (by ticking yes to one box below):

- I am carrying on or proposing to carry on a business which involves the use of the premises for licensable activities; or
- I am making the application pursuant to a statutory function or
- a function discharged by virtue of Her Majesty's prerogative

**(A) INDIVIDUAL APPLICANTS (fill in as applicable)**

Mr <input checked="" type="checkbox"/>	Mrs <input type="checkbox"/>	Miss <input type="checkbox"/>	Ms <input type="checkbox"/>	Other Title (for example, Rev)	
Surname <b>GOCEN</b>			First names <b>ANIL</b>		
Date of birth			I am 18 years old or over <input checked="" type="checkbox"/> Please tick yes		
Nationality					
Current residential address if different from premises address					
Post town			Postcode		
Daytime contact telephone number					
E-mail address (optional)					

**SECOND INDIVIDUAL APPLICANT (if applicable)**

Mr <input type="checkbox"/>	Mrs <input type="checkbox"/>	Miss <input type="checkbox"/>	Ms <input type="checkbox"/>	Other Title (for example, Rev)	
Surname			First names		
Date of birth		I am 18 years old or over		<input type="checkbox"/>	Please tick yes
Nationality					
Current postal address if different from premises address					
Post town				Postcode	
Daytime contact telephone number					
E-mail address (optional)					

**(B) OTHER APPLICANTS**

**Please provide name and registered address of applicant in full. Where appropriate please give any registered number. In the case of a partnership or other joint venture (other than a body corporate), please give the name and address of each party concerned.**

Name
Address
Registered number (where applicable)
Description of applicant (for example, partnership, company, unincorporated association etc.)
Telephone number (if any)
E-mail address (optional)



**Part 3 Operating Schedule**

When do you want the premises licence to start?

DD MM YYYY  
01 09 2017

If you wish the licence to be valid only for a limited period, when do you want it to end?

DD MM YYYY  
[ ][ ][ ][ ][ ][ ][ ][ ][ ]

Please give a general description of the premises (please read guidance note 1)

BAR AND LOUNGE RESTAURANT WITH  
LIVE AND RECORDED MUSIC  
ALCOHOL SERVICE  
LATE NIGHT REFRESHMENT

If 5,000 or more people are expected to attend the premises at any one time, please state the number expected to attend.

[ ]

What licensable activities do you intend to carry on from the premises?

(please see sections 1 and 14 and Schedules 1 and 2 to the Licensing Act 2003)

Provision of regulated entertainment (please read guidance note 2)

Please tick all that apply

- a) plays (if ticking yes, fill in box A)
- b) films (if ticking yes, fill in box B)
- c) indoor sporting events (if ticking yes, fill in box C)
- d) boxing or wrestling entertainment (if ticking yes, fill in box D)
- e) live music (if ticking yes, fill in box E)
- f) recorded music (if ticking yes, fill in box F)
- g) performances of dance (if ticking yes, fill in box G)
- h) anything of a similar description to that falling within (e), (f) or (g) (if ticking yes, fill in box H)

Provision of late night refreshment (if ticking yes, fill in box I)

Supply of alcohol (if ticking yes, fill in box J)

In all cases complete boxes K, L and M

**A**

Plays Standard days and timings (please read guidance note 7)			Will the performance of a play take place <u>indoors or outdoors or both – please tick</u> (please read guidance note 3)	Indoors	<input type="checkbox"/>
Day	Start	Finish		Outdoors	<input type="checkbox"/>
				Both	<input type="checkbox"/>
Mon				<b><u>Please give further details here</u></b> (please read guidance note 4)	
Tue					
Wed			<b><u>State any seasonal variations for performing plays</u></b> (please read guidance note 5)		
Thurs					
Fri			<b><u>Non standard timings. Where you intend to use the premises for the performance of plays at different times to those listed in the column on the left, please list</u></b> (please read guidance note 6)		
Sat					
Sun					

**B**

<b>Films</b> Standard days and timings (please read guidance note 7)			<b>Will the exhibition of films take place indoors or outdoors or both – please tick</b> (please read guidance note 3)	Indoors	<input type="checkbox"/>
				Outdoors	<input type="checkbox"/>
				Both	<input type="checkbox"/>
<b>Day</b>	<b>Start</b>	<b>Finish</b>	<b>Please give further details here</b> (please read guidance note 4)		
Mon					
			<b>State any seasonal variations for the exhibition of films</b> (please read guidance note 5)		
Tue					
			<b>Non standard timings. Where you intend to use the premises for the exhibition of films at different times to those listed in the column on the left, please list</b> (please read guidance note 6)		
Wed					
Thurs					
Fri					
Sat					
Sun					

C

Indoor sporting events Standard days and timings (please read guidance note 7)			<u>Please give further details</u> (please read guidance note 4)	
Day	Start	Finish		
Mon			<u>State any seasonal variations for indoor sporting events</u> (please read guidance note 5)	
Tue				
Wed				<u>Non standard timings. Where you intend to use the premises for indoor sporting events at different times to those listed in the column on the left, please list</u> (please read guidance note 6)
Thurs				
Fri				
Sat				
Sun				

**D**

<b>Boxing or wrestling entertainments</b> Standard days and timings (please read guidance note 7)			<b><u>Will the boxing or wrestling entertainment take place indoors or outdoors or both – please tick (please read guidance note 3)</u></b>	Indoors	<input type="checkbox"/>
				Outdoors	<input type="checkbox"/>
				Both	<input type="checkbox"/>
<b>Day</b>	<b>Start</b>	<b>Finish</b>	<b><u>Please give further details here (please read guidance note 4)</u></b>		
Mon					
Tue			<b><u>State any seasonal variations for boxing or wrestling entertainment (please read guidance note 5)</u></b>		
Wed					
Thurs			<b><u>Non standard timings. Where you intend to use the premises for boxing or wrestling entertainment at different times to those listed in the column on the left, please list (please read guidance note 6)</u></b>		
Fri					
Sat					
Sun					

**E**

<b>Live music</b> Standard days and timings (please read guidance note 7)			<b><u>Will the performance of live music take place indoors or outdoors or both – please tick</u></b> (please read guidance note 3)	Indoors	<input checked="" type="checkbox"/>			
				Outdoors	<input type="checkbox"/>			
				Both	<input type="checkbox"/>			
<b>Day</b>	<b>Start</b>	<b>Finish</b>	<b><u>Please give further details here</u></b> (please read guidance note 4)					
Mon	18:00	24:00						
Tue	18:00	24:00						
Wed	18:00	24:00				<b><u>State any seasonal variations for the performance of live music</u></b> (please read guidance note 5)		
Thurs	18:00	24:00						
Fri	18:00	01:30				<b><u>Non standard timings. Where you intend to use the premises for the performance of live music at different times to those listed in the column on the left, please list</u></b> (please read guidance note 6)		
Sat	18:00	02:00						
Sun	18:00	24:00						

**F**

Recorded music Standard days and timings (please read guidance note 7)			Will the playing of recorded music take place <u>indoors or outdoors or both</u> – please tick (please read guidance note 3)	Indoors	<input checked="" type="checkbox"/>
				Outdoors	<input type="checkbox"/>
				Both	<input type="checkbox"/>
Day	Start	Finish			
Mon	18:00	24:00	<b>Please give further details here</b> (please read guidance note 4)		
Tue	18:00	24:00			
Wed	18:00	24:00	<b>State any seasonal variations for the playing of recorded music</b> (please read guidance note 5)		
Thurs	18:00	24:00			
Fri	18:00	01:30	<b>Non standard timings. Where you intend to use the premises for the playing of recorded music at different times to those listed in the column on the left, please list</b> (please read guidance note 6)		
Sat	18:00	02:00			
Sun	18:00	24:00			

G

<b>Performances of dance</b> Standard days and timings (please read guidance note 7)			<b>Will the performance of dance take place indoors or outdoors or both – please tick</b> (please read guidance note 3)	Indoors	<input type="checkbox"/>
				Outdoors	<input type="checkbox"/>
				Both	<input type="checkbox"/>
<b>Day</b>	<b>Start</b>	<b>Finish</b>	<b>Please give further details here</b> (please read guidance note 4)		
Mon					
Tue					
Wed			<b>State any seasonal variations for the performance of dance</b> (please read guidance note 5)		
Thurs			<b>Non standard timings. Where you intend to use the premises for the performance of dance at different times to those listed in the column on the left, please list</b> (please read guidance note 6)		
Fri					
Sat					
Sun					



# H

<b>Anything of a similar description to that falling within (e), (f) or (g)</b> Standard days and timings (please read guidance note 7)			Please give a description of the type of entertainment you will be providing		
<b>Day</b>	<b>Start</b>	<b>Finish</b>	<b><u>Will this entertainment take place indoors or outdoors or both – please tick</u></b> (please read guidance note 3)	<b>Indoors</b>	<input type="checkbox"/>
Mon				<b>Outdoors</b>	<input type="checkbox"/>
				<b>Both</b>	<input type="checkbox"/>
Tue			<b><u>Please give further details here</u></b> (please read guidance note 4)		
Wed					
Thurs			<b><u>State any seasonal variations for entertainment of a similar description to that falling within (e), (f) or (g)</u></b> (please read guidance note 5)		
Fri					
Sat			<b><u>Non standard timings. Where you intend to use the premises for the entertainment of a similar description to that falling within (e), (f) or (g) at different times to those listed in the column on the left, please list</u></b> (please read guidance note 6)		
Sun					

I

<b>Late night refreshment</b> Standard days and timings (please read guidance note 7)			<b>Will the provision of late night refreshment take place indoors or outdoors or both – please tick (please read guidance note 3)</b>	Indoors	<input checked="" type="checkbox"/>
				Outdoors	<input type="checkbox"/>
				Both	<input type="checkbox"/>
<b>Day</b>	<b>Start</b>	<b>Finish</b>	<b><u>Please give further details here (please read guidance note 4)</u></b>		
Mon	23:00	24:00			
Tue	23:00	24:00			
Wed	23:00	24:00			
			<b><u>State any seasonal variations for the provision of late night refreshment (please read guidance note 5)</u></b>		
Thurs	23:00	24:00	<b><u>Non standard timings. Where you intend to use the premises for the provision of late night refreshment at different times, to those listed in the column on the left, please list (please read guidance note 6)</u></b>		
Fri	23:00	01:30			
Sat	23:00	02:00			
Sun	23:00	24:00			

**J**

Supply of alcohol Standard days and timings (please read guidance note 7)			Will the supply of alcohol be for consumption — please tick (please read guidance note 8)	On the premises	<input checked="" type="checkbox"/>
Day	Start	Finish		Off the premises	<input type="checkbox"/>
Mon	10:00	24:00	<b>State any seasonal variations for the supply of alcohol</b> (please read guidance note 5)	Both	<input type="checkbox"/>
Tue	10:00	24:00			
Wed	10:00	24:00			
Thurs	10:00	24:00		<b>Non standard timings. Where you intend to use the premises for the supply of alcohol at different times to those listed in the column on the left, please list</b> (please read guidance note 6)	
Fri	10:00	01:30			
Sat	10:00	02:00			
Sun	10:00	24:00			

State the name and details of the individual whom you wish to specify on the licence as designated premises supervisor (Please see declaration about the entitlement to work in the checklist at the end of the form):

Name	FUNDA YENIDOGAN
Date of birth	
Address	
Postcode	
Personal licence number (if known)	LN/2015000331
Issuing licensing authority (if known)	ENFIELD COUNCIL

□□□□

K

**Please highlight any adult entertainment or services, activities, other entertainment or matters ancillary to the use of the premises that may give rise to concern in respect of children (please read guidance note 9).**

L

<b>Hours premises are open to the public Standard days and timings (please read guidance note 7)</b>			<b>State any seasonal variations (please read guidance note 5)</b>
<b>Day</b>	<b>Start</b>	<b>Finish</b>	
Mon	09:00	01:00	
Tue	09:00	01:00	
Wed	09:00	01:00	
Thurs	09:00	01:00	
Fri	09:00	02:30	
Sat	09:00	03:00	
Sun	09:00	01:00	

**Non standard timings. Where you intend the premises to be open to the public at different times from those listed in the column on the left, please list (please read guidance note 6)**

**M** Describe the steps you intend to take to promote the four licensing objectives:

**a) General – all four licensing objectives (b, c, d and e) (please read guidance note 10)**

OUR MAIN OBJECTIVES ARE PROTECT THE PUBLIC AND PREVENT THE NUISANCE DURING THE ANY LICENSABLE ACTIVITIES.

**b) The prevention of crime and disorder**

CAMERAS ARE SITED AND IN FULL FUNCTION 24HRS A DAY, WHICH OBSERVES THE ENTRANCE AND EXIT DOORS AS WELL AS THE BAR AND BEER GARDEN.  
PROFESSIONAL SECURITY WILL BE ON DUTY AT THE MAIN ENTRANCE AND EXIT AT WEEKENDS.  
ID WILL BE CHECKED ON WEEKENDS BY A ID SECURITY CHECK SYSTEM INSTALLED AT THE MAIN ENTRANCE.

**c) Public safety**

THE MAXIMUM NUMBER OF PERSONS ON THE PREMISES AT ANY ONE TIME SHALL NOT EXCEED 90.  
SUITABLE BEVERAGES OTHER THAN ALCOHOL (INCLUDING DRINKING WATER) SHALL BE EQUALLY AVAILABLE FOR CONSUMPTION WITH OR OTHERWISE AS ANCILLARY TO TABLE MEALS.  
SHOULD THE PREMISES REMAIN OPEN FOR NON-LICENSABLE ACTIVITIES CUSTOMER SHALL NOT HAVE ACCESS TO ALCOHOL AFTER THE LICENSED HOURS.

(CONT ON SEPERATE PAGE.)

**d) The prevention of public nuisance**

A SUBSTANTIAL AMOUNT OF THE BUDGET WAS SPENT ON SOUND PROOFING IN ORDER TO PREVENT ESCAPE OF SOUND OR LIMIT IT TO MINIMUM.  
ALL EXTERNAL DOORS AND WINDOWS TO BE KEPT CLOSED BUT NOT LOCKED WHILST LIVE OR RECORDED MUSIC IS BEING PLAYED.

(CONT ON SEPERATE SHEET...)

**e) The protection of children from harm**

ALL STAFF SHALL RECEIVE INDUCTION AND REFRESHER (AT LEAST EVERY 3 MONTHS) RELATING TO THE SALE OF ALCOHOL AND THE TIMES AND CONDITIONS OF THE PREMISES LICENCE.  
NO ONE UNDER THE AGE OF 18 YEARS SHALL BE PERMITTED TO ENTER THE PREMISES AND SERVED WITH ALCOHOL UNLESS ACCOMPANIED BY AN ADULT.

(CONT ON SEPERATE SHEET...)

CONTINUED:

## Public Safety:

- At least 2 members of staff shall be present on the shop floor of the premises at all times, the premises are open for licensable activities / from opening to until closing.

## The Prevention of Public Nuisance:

- The management shall make subjective assessment of noise levels outside at the perimeter of the premises approximately 50m, whilst regulated entertainment is provided to ensure that noise from the premises does not cause a disturbance to local residents. Records shall be kept of the times, dates and any issues discovered. These records shall be kept for six months. Records must be made available to an authorised officer of the Council or police, upon request. Where monitoring by staff identifies that noise from the premises is audible at the perimeter, measures shall be taken to reduce this i.e. turning volume down.

- The external area at the front of the premises shall be designated for the use of smokers from 10:00 hours until 23:00. The designated area shall be adequately supervised to control the number and behaviour of patrons so as to not cause noise nuisance. Notices shall be displayed in the area specifying the terms of its use and asking patrons to respect the needs of local residents and use the area quietly.

CONTINUED:

## The Prevention of Public Nuisance cont...

- At the conclusion of all regulated entertainment events a suitably worded announcement shall be made to the customers, requesting that they behave in a quiet manner whilst they are leaving the premises.
- Prominent, clear and legible notices shall be displayed at all public exits from the premises requesting customers respect the needs of local residents and leave the premises quietly. These notices shall be positioned at eye level and in a location where those leaving the premises can read them.
- Staff shall actively discourage patrons from congregating around the outside of the premises.
- The premises licence holder shall ensure that the pavement from the building line to the kerb edge immediately outside the premises, including the gutter channel at its junction with the kerb edge, is kept clean and free from litter at all material times to the satisfaction of the Licensing Authority.
- Prominent, clear and legible notices shall be displayed at all public exits from the premises requesting customers respect the surrounding area and dispose of litter in a responsible manner. These notices shall be positioned at eye level and in a location where those leaving the premises can read them.
- Litter bins and wall mounted ashtrays shall be provided outside the premises.
- All refuse and bottles shall be disposed of in bins quietly so as not to disturb neighbours or local residents. There shall be no disposal of glass bottles outside between 23:00 hours and 07:00 hours.
- Deliveries will not be made to the premises between the hours of 18:00 and 07:00.

CONTINUED...

## The Protection of children from harm:

- Children under the age of 18 are not permitted in the areas of licensable activities.
- Those under the age of 18 shall only be allowed on the premises to dine in the restaurant area and only when accompanied by an adult.
- Any children on the premises after 19:30 must be there for the purpose of consuming a substantial meal and be accompanied by an adult.
- A personal licence holder is to be present on the premises and supervise the sale of alcohol, through the permitted hours for the sale of alcohol.
- All training relating to the sale of alcohol and times and conditions of the premises licence shall be documented and records kept at the premises. These records shall be made available to the Police and/or Local Authority upon request and shall be kept for at least one year.
- The Local Authority or similar proof of age scheme shall be operated and relevant material shall be displayed at the premises. Only passport photographic driving licences or ID with the P.A.S. logo (Proof of age Standards Scheme) may be accepted.
- A written record of refused sales shall be kept on the premises and completed when necessary. This record shall be made available to Police and/or the Local Authority upon request and shall be kept for at least one year from the date of the last entry.



**Checklist:**

**Please tick to indicate agreement**

- I have made or enclosed payment of the fee.
- I have enclosed the plan of the premises.
- I have sent copies of this application and the plan to responsible authorities and others where applicable.
- I have enclosed the consent form completed by the individual I wish to be designated premises supervisor, if applicable.
- I understand that I must now advertise my application.
- I understand that if I do not comply with the above requirements my application will be rejected.
- [Applicable to all individual applicants, including those in a partnership which is not a limited liability partnership, but not companies or limited liability partnerships] I have included documents demonstrating my entitlement to work in the United Kingdom (please read note 15).

**IT IS AN OFFENCE, UNDER SECTION 158 OF THE LICENSING ACT 2003, TO MAKE A FALSE STATEMENT IN OR IN CONNECTION WITH THIS APPLICATION. THOSE WHO MAKE A FALSE STATEMENT MAY BE LIABLE ON SUMMARY CONVICTION TO A FINE OF ANY AMOUNT.**

**IT IS AN OFFENCE UNDER SECTION 24B OF THE IMMIGRATION ACT 1971 FOR A PERSON TO WORK WHEN THEY KNOW, OR HAVE REASONABLE CAUSE TO BELIEVE, THAT THEY ARE DISQUALIFIED FROM DOING SO BY REASON OF THEIR IMMIGRATION STATUS. THOSE WHO EMPLOY AN ADULT WITHOUT LEAVE OR WHO IS SUBJECT TO CONDITIONS AS TO EMPLOYMENT WILL BE LIABLE TO A CIVIL PENALTY UNDER SECTION 15 OF THE IMMIGRATION, ASYLUM AND NATIONALITY ACT 2006 AND PURSUANT TO SECTION 21 OF THE SAME ACT, WILL BE COMMITTING AN OFFENCE WHERE THEY DO SO IN THE KNOWLEDGE, OR WITH REASONABLE CAUSE TO BELIEVE, THAT THE EMPLOYEE IS DISQUALIFIED.**

**Part 4 – Signatures (please read guidance note 11)**

**Signature of applicant or applicant’s solicitor or other duly authorised agent (see guidance note 12). If signing on behalf of the applicant, please state in what capacity.**

<b>Declaration</b>	<ul style="list-style-type: none"> <li>• [Applicable to individual applicants only, including those in a partnership which is not a limited liability partnership] I understand I am not entitled to be issued with a licence if I do not have the entitlement to live and work in the UK (or if I am subject to a condition preventing me from doing work relating to the carrying on of a licensable activity) and that my licence will become invalid if I cease to be entitled to live and work in the UK (please read guidance note 15).</li> <li>• The DPS named in this application form is entitled to work in the UK (and is not subject to conditions preventing him or her from doing work relating to a licensable activity) and I have seen a copy of his or her proof of entitlement to work, if appropriate (please see note 15)</li> </ul>
<b>Signature</b>	---
<b>Date</b>	04/08/17
<b>Capacity</b>	







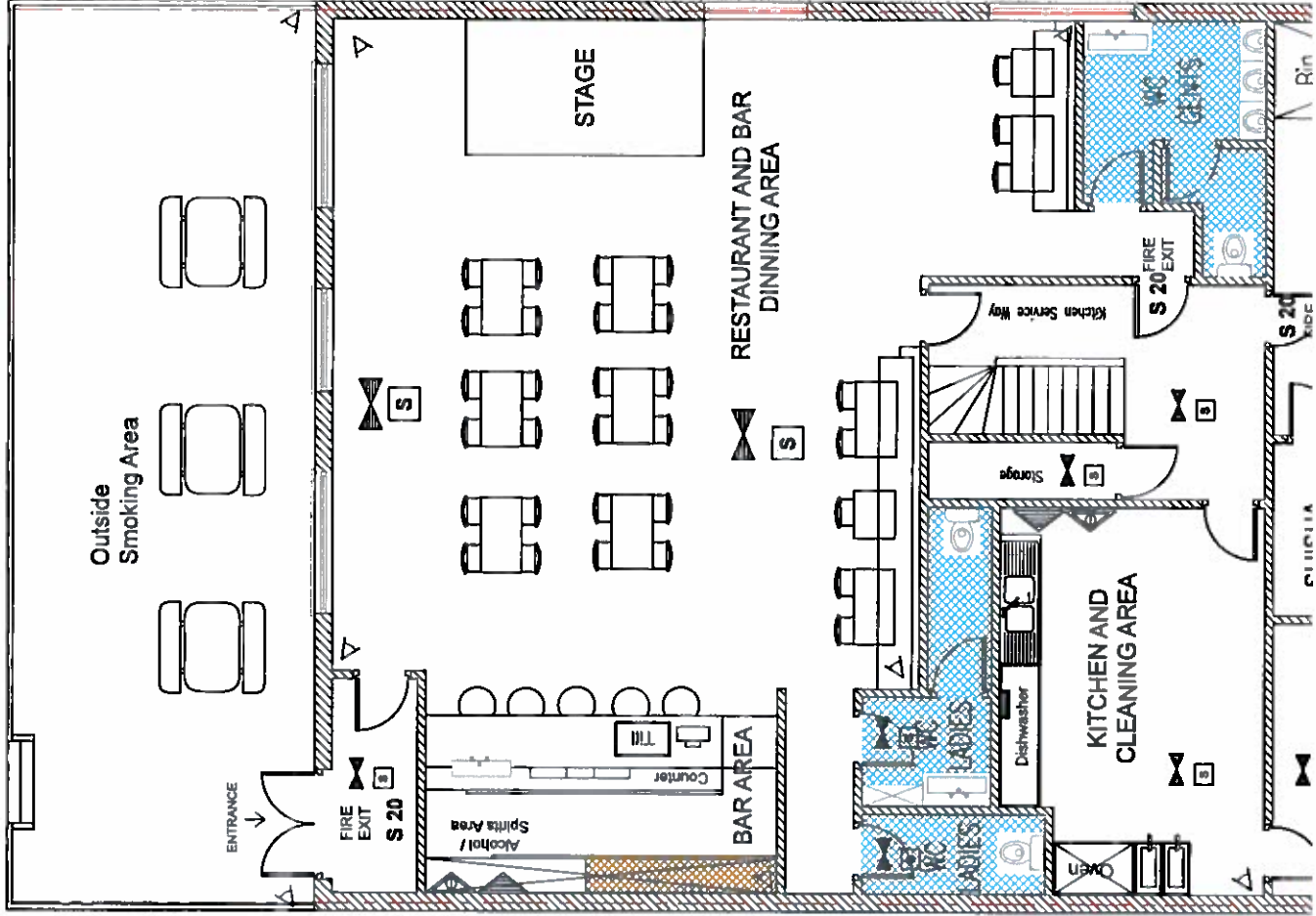





**For joint applications, signature of 2<sup>nd</sup> applicant or 2<sup>nd</sup> applicant’s solicitor or other authorised agent (please read guidance note 13). If signing on behalf of the applicant, please state in what capacity.**

<b>Signature</b>	
<b>Date</b>	
<b>Capacity</b>	

<b>Contact name (where not previously given) and postal address for correspondence associated with this application (please read guidance note 14)</b>			
<b>Post town</b>		<b>Postcode</b>	
<b>Telephone number (if any)</b>			
<b>If you would prefer us to correspond with you by e-mail, your e-mail address (optional)</b>			



**LEGEND**

-  WC AREA
-  BAR AREA
-  AMBIT OF LICENSED PREMISES
-  SAFETY LIGHTS
-  SMOKE DETECTOR
-  CARBON DIOXIDE FIRE EXTINGUISHER
-  9 LT. WATER FIRE EXTINGUISHER
-  FIRE ESCAPE KEEP CLEAR
-  CCTV
-  INTERNALLY ILLUMINATED FIRE ESCAPE SIGN (BS 5266)
-  FIRE BLANKET
-  FAN 611/s
-  FIRE ALARM BELL

**Appendix 2- Letters of representation-RAs**

## **Anderson Chanel**

---

**From:** Mark.L.Greaves@met.pnn.police.uk  
**Sent:** 31 August 2017 12:21  
**To:** Licensing  
**Cc:** Barrett Dallah  
**Subject:** Application for a New Premises Licence: - Matizz Bar and Lounge, 83 Mayes Road, Wood Green, London, N22 6TN

Dear Mrs Barrett

I am making a representation against the application for Matizz Bar & Lounge, 83 Mayes Road, London N22 6TN

This venue has been a public house for some years and over the tenure of the previous two owners has had concerns with crime and disorder and public nuisance when clients leave late at night. The venue is situated in Mayes Road at the junction with Coburg Road and is overlooked by residential properties. The venue under the previous management was subject to a review of the Premises Licence due to crime and disorder and public nuisance emanating from the venue and in December 2016 the LSG reduced the licensable hours of the venue.

Police concerns are that the application applies to open until 0100 Sunday to Thursday, until 0230 Fridays and 0300 Saturdays in a residential area. With regards the applications stated closing times there is a statement in the application: 'Should the premises remain open for non – licensable activity' which the applicant previously stated was to add an hour to the closing time to empty the premises for existing clients. As the venues capacity is stated on the application at 90 and all licensable activity stops an hour prior to 'hours open to the public' I would consider it reasonable to have emptied the venue within that hour.

The application mentions a smoking area at the front of the venue until 2300 but not where clients will smoke from 2300 until closing time. It would need to be an open area and therefore residents on the opposite side of the road may be disturbed as voices travel at night. The application mentions 'professional security which I assume means S.I.A registered Door Supervisors but only 2 and only at weekends although no times are mentioned . We ask the LSC to consider the following amendments to the application as it stands:

Police recommend there is a S.I.A registered Security Officer on each entrance to control entry and one inside monitoring clients behaviour to identify and prevent any incidents of crime and disorder from 2100 hours Monday to Sunday until venue has closed and clients dispersed.

CCTV standards not mentioned in application so Police recommend:

A digital CCTV system to be installed in the premises.

Cameras must be sited to observe the entrance doors from the inside.

Cameras on the entrances must capture full frame shots of the heads and shoulders of all people entering the premises i.e. capable of identification.

Cameras must be sited to cover all areas to which the public have access including any outside smoking areas.

Provide a linked record of the date, time of any image.

Provide good quality images.

Have a monitor to review images and recorded quality.

Be regularly maintained to ensure continuous quality of image capture and retention.

Member of staff trained in operating CCTV at venue during times open to the public.

Digital images must be kept for 31 days. The equipment must have a suitable export method, e.g. CD/DVD writer so that Police can make an evidential copy of the data they require. Copies must be available within a reasonable time to Police on request.

Police recommend:

An incident log shall be kept at the premises, it will be in a hardback durable format handwritten at the time of the incident or as near to as is reasonable and made available on request to the Police, which will record the following:

- (a) all crimes reported to the venue
- (b) all ejections of patrons
- (c) any complaints received
- (d) any incidents of disorder
- (e) seizures of drugs or offensive weapons
- (f) any faults in the CCTV system or searching equipment or scanning equipment
- (g) any refusal of the sale of alcohol
- (h) any visit by a relevant authority or emergency service.

With regards The Protection of Children from Harm Police recommend:

Challenge 25 Policy Implemented:

I recommend that the following form of verification of a person's proof of age is:

- A valid passport.
- A photo driving licence
- A proof of age standard card system
- A citizen card, supported by the Home Office.

With regards the hours of the venue Police consider they should reflect the hours previously decided by the LSC and in the case of live / recorded music requested start time by applicant, that they considered suitable for such a venue in a residential area:

Opening hours:  
Monday to Sunday                      1000 to 0000

Supply of alcohol:  
Monday to Sunday                      1000 to 2330

Live music and recorded music:  
Monday to Sunday                      1800 to 2330

Provision of late night refreshment:  
Monday to Sunday                      2300 to 2330

The outside shisha area is to close and all customers are to be asked to come inside by 2230, Monday to Sunday.

Yours sincerely

Mark Greaves

**Mark Greaves PC 164YR  
Community & Youth Engagement**

**Licensing Officer  
Haringey BOCU  
Territorial Policing**

**Tel: 020 3276 0150      Mobile: 07766 161877**

Haringey police are here

- *for victims,*
- *to build trust with communities,*
- *to prevent crime in partnership,*
- *and to bring offenders to justice.*

**This Message is Restricted/Confidential  
If Printed please remember to dispose of as Confidential Waste**

**Total Policing is the Met's commitment to be on the streets and in your communities to catch offenders, prevent crime and support victims. We are here for London, working with you to make our capital safer.**

**Consider our environment - please do not print this email unless absolutely necessary.**

**NOTICE - This email and any attachments may be confidential, subject to copyright and/or legal privilege and are intended solely for the use of the intended recipient. If you have received this email in error, please notify the sender and delete it from your system. To avoid incurring legal liabilities, you must not distribute or copy the information in this email without the permission of the sender. MPS communication systems are monitored to the extent permitted by law. Consequently, any email and/or attachments may be read by monitoring staff. Only specified personnel are authorised to conclude any binding agreement on behalf of the MPS by email. The MPS accepts no responsibility for unauthorised agreements reached with other employees or agents. The security of this email and any attachments cannot be guaranteed. Email messages are routinely scanned but malicious software infection and corruption of content can still occur during transmission over the Internet. Any views or opinions expressed in this communication are solely those of the author and do not necessarily represent those of the Metropolitan Police Service (MPS).**

**Find us at:**

**Facebook: [Facebook.com/metpoliceuk](https://www.facebook.com/metpoliceuk)**

**Twitter: [@metpoliceuk](https://twitter.com/metpoliceuk)**

## **Anderson Chanel**

---

**From:** Licensing  
**Subject:** FW: WK389510 - RE: Application for a New Premises Licence: - Matizz Bar and Lounge, 83 Mayes Road, Wood Green, London, N22 6TN (WK/378525)

**From:** Tamba Lamin  
**Sent:** 04 September 2017 16:41  
**To:** Shipp David <David.Shipp@haringey.gov.uk>; Licensing <Licensing.Licensing@haringey.gov.uk>  
**Cc:** Charles Rockwell <Rockwell.Charles@haringey.gov.uk>; Barrett Daliah <Daliah.Barrett@haringey.gov.uk>  
**Subject:** WK389510 - RE: Application for a New Premises Licence: - Matizz Bar and Lounge, 83 Mayes Road, Wood Green, London, N22 6TN (WK/378525)

### **Licensing Consultation**

**To:** Licensing Officer

**From:** Enforcement Response Officer (Noise)

**Name of Officer preparing representation:** Lamin Tamba

**Our Reference:** WK/000389510

**Date:** 4th September 2017

**Premises:** Matizz Bar & Lounge, 83 Mayes Road, Wood Green, London, N22 6TN

**Type of application:** New

---

I would like to confirm that I have considered the above proposal with regard to the prevention of public nuisance on behalf of the Enforcement Response (Noise) Team & would like to make representations to the Application

The operating schedule does not address the prevention of public nuisance from:

- airborne entertainment noise
- Structure borne noise or vibrations from entertainment
- Noise generated by patrons in external areas of the premises
- Noise generated from patrons queuing to enter
- Noise from patrons exiting the premises
- Noise from plant and machinery
- Light nuisance
- Cooking odour

The proposed operating hours are inappropriate due to the close proximity of residential dwellings.

The noise caused by patrons exiting the premises and locating suitable transport home is likely to be detrimental to the residential amenity. This may be exacerbated by the level of public transport available at the proposed closing hours.

### **Supporting Information**



Since the change of name/management, no public nuisance was witnessed by this department.

The most recent photo of the front of the premises is attached for your perusal



This representation recommends that the following alterations/conditions to the operating schedule:

**Operating hours**

That the premises closes no later than 24:00

That regulated entertainment ceases at 23:30.

Reason: The close proximity of residential premises. To allow for a quiet/slow egress of patrons from the premises.

**Prevention of nuisance from noise / vibration**

All doors and windows will remain closed during the licensed regulated entertainment activities or in any event after 11pm. The entrance door will be fitted with a self-closing device and staff required to ensure that it is not propped open. A member of staff shall be made responsible to ensure the door is opened for as brief a period as possible. Where necessary adequate and suitable mechanical ventilation should be provided to public areas

Entry to the premises will be restricted to *the front main door on Mayes Road* whilst the premises is being used for regulated entertainment licensed activity

Entrance/exit from the premises whilst regulated entertainment licensable activities are ongoing shall be via a lobbied door to minimise noise breakout.

The regulated entertainment licensable activity shall conclude 30 minutes before the premises is due to close to prevent excessive noise breakout as the premises empties

### *Structure borne noise*

All speakers are mounted on anti-vibration mountings to prevent vibration transmission of sound energy to adjoining properties

### *Sound limits*

The licensee shall ensure that no music played in the licensed premises is audible at or within the site boundary of any residential property

All regulated entertainment amplified activity will utilise the in-house amplification system, the maximum output of which is controlled by the duty manager

### *Outside Areas*

No music will be played in, or for the benefit of patrons in external areas of the premises

No form of loudspeaker or sound amplification equipment is to be sited on or near the exterior premises or in or near any foyer, doorway, window or opening to the premises

Signs shall be displayed in the external areas/on the frontage requesting patrons to recognise the residential nature of the area and conduct their behaviour accordingly. The management must reserve the right to ask patrons to move inside the premises or leave if it is felt that they could be disturbing neighbours

The number of persons permitted to utilise the external area/frontage will be restricted to 16.

Only patrons seated at tables will be permitted in the beer garden

The external area /frontage will be closed and patrons requested to come inside the main structure of the premises at 21:30.

### *Deliveries and collections.*

Empty bottles and non-degradable refuse will remain in the premises at the end of trading hours and taken out to the refuse point at the start of the working day rather than at the end of trading when neighbours might be unduly disturbed

### *Plant and machinery*

All plant and machinery is correctly maintained and regularly serviced to ensure that it is operating efficiently and with minimal disturbance to neighbours arising from noise

### *Dealing with complaints*

A complaints book will be held on the premises to record details of any complaints received from neighbours. The information is to include, where disclosed, the complainant's name, location, date time and subsequent remedial action undertaken. This record must be made available at all times for inspection by council officers

Regular *bi monthly* liaison meetings will be held where specifically requested by residents to enable neighbours to raise concerns about any aspect of the licensed activities

Patrons entering/exiting premises.

There will be no queuing outside the premises.

Where people queue to enter the premises a licensed door supervisor shall supervise and ensure the potential patrons behave in an acceptable manner

Signs should be displayed requesting patrons to respect the neighbours and behave in a courteous manner

#### Door supervisors

When the premises turn out, a licensed door supervisor shall supervise patrons and ensure they leave in a prompt and courteous manner, respecting the neighbours.

A licensed door supervisor will be positioned on the exit door to ensure, as far as reasonably practical, that patrons do not leave drinks.

#### *Prevention of Nuisance from Odour*

All ventilation and extraction systems shall be correctly maintained and regularly serviced to ensure that it is operating efficiently and with minimal disturbance to neighbours arising from odour.

#### Prevention of nuisance from light

Illuminated external signage shall be switched off when the premises is closed

Security lights will be positioned to minimise light intrusion to nearby residential premises

## **Anderson Chanel**

---

**From:** Barrett Daliah  
**Sent:** 24 August 2017 16:48  
**To:** Anderson Chanel  
**Subject:** FW: LICENSING AUTHORITY REPRESENTATION- Application for a New Premises Licence: - Matizz Bar and Lounge, 83 Mayes Road, Wood Green, London, N22 6TN

Dear Sirs,

We are making representation against the application for Matizz Bar and Lounge, 83 Mayes Road, London N22.

The main reason for making the representation is that the premises were subject to a recent review due to the negative impact from the late night operation of the venue on local residents and the applicant seeks to operate another late night venue at this locality which has been proven to not be suited for such late night activity as it is predominantly residential.

The application seeks the following:

Regulated Entertainment: Live Music & Recorded Music

Sunday to Thursday	1800 to 0000 hours
Friday	1800 to 0130 hours
Saturday	1800 to 0200 hours

Late Night Refreshment

Sunday to Thursday	2300 to 0000 hours
Friday	2300 to 0130 hours
Saturday	2300 to 0200 hours

Supply of Alcohol

Sunday to Thursday	1000 to 0000 hours
Friday	1000 to 0130 hours
Saturday	1000 to 0200 hours

For the consumption ON the premises

Hours Open to Public:

Sunday to Thursday	0900 to 0100 hours
Friday	2300 to 0230 hours
Saturday	2300 to 0300 hours

An application for a review of the current premises licence at the address was previously undertaken by residents and determined by the LSC in December 2016. The review was brought due to ongoing public nuisance issues and crime and disorder emanating from the venue which impacted on nearby residents. Then premises is set along Mayes Road and has a side entrance on Coburg Road which leads into an area that was being used for shisha smoking. Noise from patrons emanating from the premises, standing outside on Coburg Road talking and shouting as well as fights taking place in the early hours of the morning had a cumulative impact on those living nearby. Residents kept diaries and logs of ongoing issues with the late operation of the venue that caused problems over a 2 year period.

It is concerning that the new applicant has submitted another application seeking such late hours at a venue that has now been shown to not be suited for such hours. Since the LSC pulled back the closing times of the venue to midnight and licensable activity finishing 30 minutes beforehand there has been a reduction in complaints from residents who had previously been affected. The applicant previously submitted an application to increase the hours but this application failed as it became apparent that the plans submitted were not reflective of the current layout of the premises.

The fact that the applicant is requesting these hours raises questions on the potential impact and the likely effect that increasing the hours will have on those living nearby.

The Home Office Guidance issued under Section 182 Guidance places a requirement on applicants to demonstrate when setting out steps they propose to take to promote the licensing objectives that they understand the area .

The Council Statement of Licensing Policy advises the following in this instance:  
**53 LICENSING HOURS**

The Council will generally deal with the issue of licensing hours having due regard to the individual merits of each application, considering the potential for nuisance associated with the style, characteristics and activities of the business and type of premises, examining any steps that might reduce the risk of nuisance.

However, although the Council will treat each case on its individual merits, generally it will not grant permission for licensable activities beyond 2330 hours on Sundays to Thursdays and Midnight on Fridays and Saturdays in respect of public houses situated in areas having denser residential accommodation. The Council would expect good reasons to be given to support any application for extensions beyond these hours, including addressing possible disturbance to residents and local parking. Additionally, in these areas, consideration will be given to imposing stricter conditions in respect of noise control.

#### **80 THE PREVENTION OF PUBLIC NUISANCE**

Licensed premises, especially those that operate late at night or in the early hours of the morning, can give rise to a range of nuisances that may potentially impact on people living, working or sleeping in the vicinity of the premises. Principal concerns relate to noise nuisance, light pollution and noxious smells.

This authority expects applicants for premises licences and club premises certificates to have made relevant enquiries about the local area and prepare their operating schedule on the basis of a risk assessment of the potential sources of nuisance posed to the local community by their intended operation. The operating schedule should demonstrate an understanding of the level of risk of nuisance and include positive proposals to manage any potential risks.

We cannot support the application in its current request, we ask the LSC to consider the following amendments to the application:

Opening hours:

Monday to Sunday: 1000 to 0000

Supply of alcohol:

Monday to Sunday: 1000 to 2330

Live music and recorded music:

Monday to Sunday: 1000 to 2330

Provision of late night refreshment:

Monday to Sunday: 2300 to 2330

The outside shisha/smoking area is to close and all customers are to be asked to come inside by 2230, Monday to Sunday. No amplified music to be played in the external area. This is to avoid any potential for noise nuisance to nearby residents. That there be an effective dispersal policy to ensure that patrons are encouraged to leave the area quickly and quietly and not enabled to hang around on the Coburg Road Side of the premises at any time.



Haringey Council  
6th Floor, 10 Station Road, London, N22 7TR

T. 020 8489 8232

[www.haringey.gov.uk](http://www.haringey.gov.uk)

[twitter@haringeycouncil](mailto:twitter@haringeycouncil)

[facebook.com/haringeycouncil](https://www.facebook.com/haringeycouncil)

Please consider the environment before printing this email.

This email and any files transmitted with it are confidential, may be subject to legal privilege and are intended only for the person(s) or organisation(s) to whom this email is addressed. Any unauthorised use, retention, distribution, copying or disclosure is strictly prohibited. If you have received this email in error, please notify the system administrator at Haringey Council immediately and delete this e-mail from your system. Although this e-mail and any attachments are believed to be free of any virus or other defect which might affect any computer or system into which they are received and opened, it is the responsibility of the recipient to ensure they are virus free and no responsibility is accepted for any loss or damage from receipt or use thereof. All communications sent to or from external third party organisations may be subject to recording and/or monitoring in accordance with relevant legislation.

**Appendix 3- Letters of representation –Residents**

HARINGEY COUNCIL  
LICENSING  
RECEIVED

18 AUG 2017

Dear Ms. Daliah Barrett-Williams it's recently come to my attention that the Matizz Bar has applied to the licensing Committee for an extension to 2. am to their present deadline of 12. midnight 7. days a week. Naturally when i heard about the extension request from the Matizz Bar i contacted the licensing Committee to confirm what i had already heard from a source who is very reliable. I'm not surprised in the least that the Matizz Bar would make an application to the licensing Committee for an extension to the present license, which must be hurting them financially as their options are limited in what they can actually do to attract into the Matizz Bar, which does beg the question as to why are requesting a 2. am extension of their present license, which only permits them open until midnight when they must close. and in the present circumstances the midnight shutdown operates 7 days a week. Not long after the Matizz Bar was operating. on three consecutive evenings i contacted the noise abatement team concerning the Matizz Bar where a jinger and loud music could be heard from " please turn over "



the area at the rear of the Matizz Bar which is allocated to people who smoke Shisha pipes, as I have no doubt at all that music should not be played at all at the rear of the Matizz Bar as that was an area allocated for the purpose already stated. There was another occasion when the police had to be called to the Matizz Bar due to an argument that was taking place inside the Matizz Bar where there was a considerable number of travellers, and I could hear the noise coming from the Matizz Bar, and I opened my front door where I came across two women who were actually urinating where the bins are situated, and I told both of them to get themselves back to the Matizz Bar where the noise was still ongoing until it eventually stopped well after midnight, as these were reluctant to go, anyway these incidents did take place and will be logged. As stated previously in my letter I am not against people who want to socialise and enjoy themselves, but I draw the line where the Matizz Bar have requested an extension of 2 AM, and the questions need to be asked what this extension actually means and where it will lead. I truly believe that the owners of the Matizz Bar should consider their circumstances very carefully and cease indulging in their fantasies as it has to be born in that this is a neighbourhood where

people live and work and have children  
as i sincerely hope that the management  
of the Matizz Bar submit a comprehensive  
busin plan to the sub-committee so that  
everybody concerned can understand of  
why the Matizz Bar are requestin a 2. am  
extension of their present license. As i have  
already stated i'm apposed to the 2. am  
extension as it will mean more people who  
will come by car, and they leave more noise  
when they turn on their car stereos where  
tend to hang around outside where i  
live and other people as well who live  
in Coburg Road and along Mayes Road.

There have been changes, but they cosmetic  
in the day to day running of the Matizz  
Bar. I sincerely hope that the sub-committee  
will look carefully at this proposed license  
extension of 2. am, as i'm apposed to it  
but can without hesitation that i will  
not be alone in my opposition to the  
proposed extension of 2. am requested  
by the Matizz Bar. As i have previously  
stated this venture would ideally suited  
to the high Road where the noise could  
be absorbed by the traffic flow on  
either side of the road, but this issue  
needs to be addressed by the sub-committee  
in a practical and common sense approach.  
I look forward to hearing from you concerning  
this matter. Yours sincerely  
Thank you.

Signed

24 AUG 2017

Dear Ms Barrett,

I would like to make representation against the application for a new premises licence for the, Matizz Bar and Lounge, 83 Mayes Road Wood Green N22 6TN (WK/389510)

It is distressing to hear that the Matizz Bar is attempting to get a new licence after we won the review at the end of December 2016 to get their time reduce because of the Anti-social behaviour and Crime and disorder that was coming from this premises for over 5 years.

Also on 4/5/17 this premises attempted again to get extra opening hours to 4am in the morning under the guys that they were new management which the committee found out to be totally untrue and the community also identified this to be totally untrue, it was a blatant attempt to mislead the committee. This organisation did not care about the detrimental effect changing the opening times to 4am in the morning which show a total disregard for the families, old people and mental health people that lived in and around the area of that bar that would have been affected, they were apathetic. But of course we should expect no different because it is the same management that cause so much disorder on our road and surrounding roads and shows the arrogances of this organisation.

It seems like this organisation forgot the distress they cause to the families which was not that long ago when it was open at 3am so common sense told them why not go a for a licence for 4 am finish. Am not sure if they were losing their heads to think the community would welcome it with open arms but in fact the community response was swift that even surprise me, over 60 signatures against this move and letters of support against this. This organisation seem surprised which was bewildering and shows how in sensitive to the situation they were and out of touch, again showing clearly the arrogance of this organisation.

My neighbours and I strongly agree that these premises should not get a new licence because; it is the same management that manages this bar. They have not even had the courtesy to change the staff. The staff that have been working for them are the same staff that cause a lot of heartache, noise and disorder and were involve in high speed racing on our roads, playing late night football in the middle of our roads and playing loud music from their cars with no disregards for the neighbours, this is well documented in my last objections to this organization.

A lot of the faces who used to go to the Pub or now is called the Matizz Bar are the same people who used to terrorize our road, are starting to return again, one of these people, who am starting to see a lot is the person I call the firer burner,

the one that likes to start fires near buildings with his friends then laugh and joke about it. I court this on video and this was sent in to the Council as part of the evidence on the first review. This person goes to the Pub a lot and will spend most of the day and night there which leads me to believe that he works for them. He is a good friend of the Ex- manager that had threatened to have me shot; of course a complaint was lodge with the Police about this threat. I have both of them on video when they were harassing us outside are houses.

Of course these people are free to go where they want, but the so call new manager said they are trying to attract a different clientele, yet he allows those people to go to his bar and even let them work for him, this is not turning over a new leave this is a continuation of the same old and this will only get worse if they are granted a time extension. They have shown again and again that there words cannot be trusted unfortunately.

### **Latest Incidents to Date**

20/6/2017 9pm Ref: T1590928

Not even six weeks after Sub-Committee meeting where the Manager of the Matizz Bar promise that we would not hear any live music coming from the bar as he said, most of his budget went into sound proving. We heard the music loud and clear. Even when I step out to the shops, I could still hear the music clearly from the end of Caxton road and onwards towards Wood Green Library. I cannot believe that they did not know this was causing a nuisance.

22/6/2017 8:58pm Ref: T1592948

Again the Matizz Bar was playing loud live music and at the same time the Karamel Restaurant was playing loud live music at the same time, it was terrible, it sounded like they were both having a competition on who can play the loudest live music. I called the noise team please referred to reference number above that was given to me by the council.

**All reference numbers seen are numbers given to me by the Noise team.**

23/6/2017 8:21pm Ref: T1593723 10:35pm Ref: T15937993

I had to call the noise team on three occasions please refer to reference numbers above. The Matizz Bar was playing loud music from the bear garden area, doors wide open. You could hear this music clean through the house. Am not sure why the management could not hear that their music was pouring out into the

road and causing a nuisance or was this an act of defiance to the community and the Sub-committee.

On 23/6/17 There were six men of Turkish descent play fighting outside are houses and were quite loud, their car was also blocking my driveway. I called one of the neighbours to witness this before i went outside to tell these men to stop fighting outside are house and to move their car. There was no SIA from the Matizz Bar in sight which was disappointing as this was their customers. Again as usual there SIAs were totally ineffective and this would just be a taster of things to come if they got an extension on their time.

These men were also speeding and were using their car horns freely.

Again this seems like a broken record with the same story.

4/7/2017 11:04pm Ref: T1604989

There was a celebration going on in the Matizz Bar for most of the evening but the noise was getting louder and louder as the evening was getting late. There was a lot of noise coming from the bear garden area it reminded me when they had football crowds and late night parties, the only way I can describe it was they sounded like animals, it was really bad. I called the noise team, please see ref number above. Later that night I went outside as I can see flashing blue lights, it was the police, there were a lot of them there as the people coming out of there were arguing amongst themselves and fighting. It turns out they were travellers. A group of women that came from the Matizz were weeing on the old people's property, it's a shame they did not feel that they could do that in the Bar. No SIA's were in sight as usual. My neighbour also came outside to look because of the noise. These people did not leave the road for a very long time and to rub salt into the wounds, you could see some of the Matizz Bar staff leaving to go to their quiet homes as they probably made enough profit for that night and it seems like it wasn't there problem anymore, leaving us with the pieces and the aftermath of their activities as usual.

14/8/2017 12:10 am

In the early hours of Sunday morning I return to my house, as I pull into Coburg road I saw three cars with a lot of guys in them, Turkish descent, the man in the middle of it, I call the firer burner was standing by the cars talking to them and seem to be making jokes, their voices were raised. One of the cars had their door wide open on the road side and they were playing loud music, I had to manoeuvre my car so it did not hit the open car door and I drove pass and park my car and I went into my house. Again no security in sight, again there SIA's go missing when they should be proactive. This person who seems to work for them did not tell these guys to go home quietly it seems like he was encouraging it. This was opposite the Matizz, no management came out to encourage these people to leave but of course they are all friends.

20/8/2017 12:28 am

A group of 12 to 15 people of male and female Turkish descent came out of the Matizz Bar singing and talking loud and shouting pass are houses. Looks like a celebration of some kind as they had silver balloons. Again no security insight or staff to manage this crowd and to tell them to leave quietly as usual. They proceeded to their cars and open their car doors, left the door wide open, turn on the car stereo loud and started to play music; they started to dance in the roads as if it was a street party. Again no security or staffs was insight to manage this. When they did eventually leave we had to put up with the slamming of car doors and the tooting of car horns and of course cars speeding off. You would of thought because of prior history that they would of manage this better but a leopard cannot change its spots.

**Note:** With the birthday celebrations we are not against people enjoying themselves but when it is at the detriment of others and you show a lack of respect and recklessness then we have a problem. And it is well documented of this type of behaviour when this organisation put on parties, there is a lack of discipline and organisation on the management part which has been a recurring theme for over 5 years, how long does it take to learn from the lessons of the past..?

These people have been playing cat and mouse with the local Authorities now for a very long time, back in August 2014 when they were repossessed and then in November 2014 reopen with the same people using a different name. When this organisation gets put under pressure they go quiet then come back with a new name but unfortunately even with a new name their behaviour remain the same, in fact at times being more arrogant. Holding back information from the Council and Police, people difficult to get a hold off. Paper work not in order, would take weeks before the authorities would be given any information. Even establishing who are the real owners of this business the organisation made the local authorities jump through hoops just to get that.

Did the Pub fully implement the last set of conditions that was imposed on them in December 2016 at the Review hearing..? and also at the Hearing on 4/5/2017..?

I cannot begin to describe the emotions and distress as we are still getting over the abusive behaviour of the last 5 years from this organisation. If the Council grants these people this licence I feel the Council would of granted these people the full licence to terrorize the most vulnerable people on our road and surrounding roads as it is mainly the elderly on our road and on the surrounding roads you have some people with mental health issues.

Since the review and getting their hours reduce, our road has been mostly peaceful for nine months. We are now being told that this bar wants to increase their opening times to as long as 3am. This would be going backwards in time to what we were experiencing before, most weekends and during the week was a guaranteed it's going to be hell, i.e. will not be able to sleep because of the noise from the bar and the garden area. Will be going back to Birthday celebrations, football matches, we heard a lot's of noise from the garden area and pub, the singing and chanting from football games from these areas. We will be going back to big parties on weekends and during the week which always brought total chaos, crime and a lot of distress to us on Coburg road and the surrounding areas, the stress this causes me, my mum, neighbours, cannot sleep properly because of the anti-social and threatening behaviour from staff and their customers. Being disturbed by the bar activities and their customers who played loud music when approaching our road and leaving our road. Their customers hanging around our road for long periods of time, loitering, playing loud music from their cars, their stereo systems often turn up to the maximum, blowing their car horns, slamming of car doors of all hours of the morning on Coburg Road. Regularly racing up and down Coburg Road and surrounding areas with their loud exhaust pipes and doing wheel spins and tires burnouts or doughnuts in the middle of our road at times close to our homes. Weeing on our walls, smoking their drugs near our property and leaving their rubbish, cigarette

ends, bottles on our walls etc. I will not be able to settle to sleep until 5 am sometimes 6 am which would be totally unreasonable. I will have to look outside my window again wondering has anyone blocked my driveway today, almost every day this was occurring. When I have to go out or go to work I was always wondering will I get out of my drive way or is a pub customer or staff, partly blocking our driveway or totally blocking our driveways, or will I be able to get back into my driveway, which could make me late. I know now this was done on purpose and we were being targeted.

We would have to go back to calling the police but not getting a response because they are over stretch but that does not help us if we are feeling threaten by the anti-social behaviour which means more heartache for my family and feeling helpless.

There were times I would turn down work because I was reluctant to leave my mum on her own because these people had no respect for the elderly and would still carry on with their abusive behaviour near our homes. At times I felt I could not go out on a weekend to socialise with my friends because I knew their SIAs were not doing their job but this was properly under instructions by their manager.

Their customers loitering regularly on the corner of Coburg road making up noise and clearly do not care that it was disturbing the neighbour's as they go out of their way to make sure everyone can hear their voices. A lot of this was done directly outside the bar on Coburg Road, and at times outside our houses, again we now know this was done on purpose. Staffs and their SIAs did nothing. In fact at times their SIAs were just as loud laughing on the top of their voices and disturbing the peace. Again we now know this was done on purpose.

Their staff and their customers would play football in the middle of our road at all hours of the night, sometimes up to 20 men, staff and customers. To date I have not received an apology for the death threat made to me and my mum.

Their reign of terror was having a detrimental effect on me, physically, socially and emotionally.

Haringey Council saw through their deceptive behaviour before and did not buckle under the pressure of a business that just cares about profit and does not care about the community clearly does not care about the effects their late night activities will have on our road and surrounding roads. We would expect the Council to send out a clear message that the ordinary man does have a voice and that we do have a right not to be abuse, feel threaten in our own homes and a right to a peaceful harmonious life and that the Council will stand up to rogue businesses that disguise themselves as genuine businesses.



Just to let you know of some of my experiences, as a, Close Protection Officer myself I have work besides Royal Close Protection and have helped protect some of the biggest names in the film and music industry.

So I would humbly and respectfully ask that this organisation is not granted a new licence as this is a residential area and not the high road; we have young children living on our road and surrounding roads and elderly and vulnerable people. All will be affected by their late night's activities and because of the late night licence it would inevitable draw the undesirables to our road and surrounding roads causing total mayhem as it did before, This is well documented from are last two objections to this business. This organisation, regardless of what name they call themselves has repeatedly fail us on Coburg Road and the surrounding roads, losing control of their customers, staff and have shown themself to be totally arrogant and insensitive to the needs of the local community, this has been demonstrated from the very strong response of the community and strong feelings that this Bar has invoke when members of the local community speaks about this organisation.

One positive thing that this bar has done for the local community is that they have brought us closer together. We are united and together on this one subject matter and are voices are getting louder. We acknowledge that they have a right to apply but we also have the right by law to object and thank god that we do have these rights because in some Countries these rights would not be respected. So we respectfully ask that this licence is not granted.

Thank you for your attention to this matter,

Kind regards,

P.s please blot out any personal information, i.e. my email address, cheers,

## **Anderson Chanel**

---

**Subject:** FW: Application for a New Premises Licence:- MATIZZ BAR AND LOUNGE, B3 MAYES ROAD, WOOD GREEN, LONDON, N22 6TN (WK/389510)-Bryan Barnes

**From:**

**Sent:** 05 September 2017 15:04

**To:** Barrett Daliah <[Daliah.Barrett@haringey.gov.uk](mailto:Daliah.Barrett@haringey.gov.uk)>

**Subject:** Re: Application for a New Premises Licence:- MATIZZ BAR AND LOUNGE, 83 MAYES ROAD, WOOD GREEN, LONDON, N22 6TN (WK/389510)-Bryan Barnes

Dear Ms Barrett,

Please can you add this to my document,

3/9/2017 6:33 pm

A customer of the Matizz Bar, male of Turkish decent parks his car blocking our driveway, there is plenty of parking spaces for this individual to park. He goes into the bar. After a while he comes back out and stands outside are house talking on the top of his voice. This goes on for about five mins, he eventually gets into his car and drives off.

This will be of things to come if they get an time extension, going back to the days when this was accruing every day, which was not long ago.

Thank you for your attention to this matter,

Kind regards,

P.s please blot out my email address, cheers.

---

**From:** Barrett Daliah <[Daliah.Barrett@haringey.gov.uk](mailto:Daliah.Barrett@haringey.gov.uk)>

**Sent:** 25 August 2017 12:28:14

**To:**

**Subject:** RE: Application for a New Premises Licence:- MATIZZ BAR AND LOUNGE, 83 MAYES ROAD, WOOD GREEN, LONDON, N22 6TN (WK/389510)-Bryan Barnes

Received.

Thank you.

Daliah Barrett

---

**From:**

**Sent:** 24 August 2017 14:01

**To:** Barrett Daliah

**Subject:** Application for a New Premises Licence:- MATIZZ BAR AND LOUNGE, 83 MAYES ROAD, WOOD GREEN, LONDON, N22 6TN (WK/389510)-Bryan Barnes

Dear Ms Barrett,

Please see attach my objections to the time extensions for the Matizz Bar.

Please sent me an email of acknowledgment, and of course when the committee will be meeting.

Again thank you for your attention to this matter.

Kind regards,

This email and any files transmitted with it are confidential, may be subject to legal privilege and are intended only for the person(s) or organisation(s) to whom this email is addressed. Any unauthorised use, retention, distribution, copying or disclosure is strictly prohibited. If you have received this email in error, please notify the system administrator at Haringey Council immediately and delete this e-mail from your system. Although this e-mail and any attachments are believed to be free of any virus or other defect which might affect any computer or system into which they are received and opened, it is the responsibility of the recipient to ensure they are virus free and no responsibility is accepted for any loss or damage from receipt or use thereof. All communications sent to or from external third party organisations may be subject to recording and/or monitoring in accordance with relevant legislation.

## Anderson Chanel

---

**From:** [REDACTED]  
**Sent:** 31 August 2017 19:20  
**To:** Licensing  
**Subject:** Matizz Bar Objection about Extended Hours Application

Dear Sir/Madam,

My name is [REDACTED] and me and my family live on the address [REDACTED]. I am writing to you because I would like to object the Matizz Bar and Lounge that are applying to extend the hours:

Sunday-Thursday: 12:00am  
Friday: 1:30am  
Saturday: 2am

It's absolutely unacceptable for us because our building is right next to the Matizz Bar and now it's very noisy. I have two children (aged 12 and 19) and they are at school. My friend [REDACTED] also lives in the same building (with her son (who is 16 years old and is also a student.) She is not happy with this hour extension either.

If you would like to contact me for more information about this my phone number is: 07460290531.

Kind Regards,

HARINGEY COUNCIL  
LICENSING  
RECEIVED

- 1 SEP 2017

**To: Haringey Licensing Team.**

**From:**

I am writing with regards to the Matizz Bar and Lounge's application to extend it's opening hours and hope you will take into account my objections:

Since the original license was granted following the Licensing sub committee meeting at the Civic Centre on 4/5/17, I have had to call the noise department on a number of occasions to complain about the noise. I am sure I am not alone in this matter. This has been a fairly regular occurrence and although the noise has reduced slightly in volume I still have to wear ear-plugs and take a sleeping pill whenever live music is played, roughly 3 or 4 times per week. I also have to close my windows and doors, which is a particularly annoying thing to have to do when the weather is warm or hot. Will you please bear in mind the impact that this business has had on my mental and physical health.

Mr Anil Gocen's application to extend opening hours to 12, 1.30 am and 2.00 am is a terrible worry for me. I had foolishly imagined that some sort of compromise had been reached and that I could tolerate things as they stand. Now I fear that every 6 months he will put in another application to extend opening hours. Mr Gocen has been very crafty and from the time notices went up there has been no live music or noise problems. I hope you will see that this is part of a carefully constructed plan. I attended the meeting on 4/5/17 and I would like to remind you of what can be politely described as the nonsense told by Mr Gocen to the sub committee and indeed Ms Barrett, representing the licensing team: he stated that:

The front area on Mayes Road would be a smoking area and that only 1 person at a time would be allowed to use it. But from day one, tables and chairs were put out for customers and obviously more than one person is allowed to smoke.

That it would be a members only establishment with a register kept of those members. Clearly this is not the case as it runs as any 'pub' would be run, open to the general public.

He agreed to the sub committee's recommendation that all complaints will be logged in a book. I cannot imagine that this has happened.

He stated that the doors would be closed at all times to reduce the noise levels. But, quite the opposite has happened and the doors are always left open.

He also claimed that he would only be playing 'background' music. But as I have said, live music takes place and whenever that happens complaints about the noise have to be put in.

Mr Gocen was also very evasive about his role as the 'owner' and it was only after a lot of questions from the sub committee that it was finally established that he was not the owner, but a manager, with links to the true owner who was responsible for previous businesses from these premises and the cause

of so much misery to local tenants.

So in short, Mr Gocen is quite prepared to say what he knows you want to hear, to the faces of the sub committee councillors and to the licensing team, without doing anything concrete. As I have said, he is being very crafty in reducing the noise at the same time as seeking to extend opening hours. I hope you will agree with me that he does not deserve any extensions considering that he is so contemptuous towards your authority. I hope you will not offer any form of compromise and will grant him not a minute of extra time. He will apply for further extensions every 6 months or so. I hope that you will see through his maneuverings as clearly as I do.

I have looked through Haringey's Statement of Licensing Policy 2016-2021: Parts 85/86/87: preventing nuisance from within premises and would urge you to consider the following areas which the Matizz Bar and Lounge has systematically failed to abide by:

**"This authority expects that the following measures will be considered and applied appropriate to the level of risk of nuisance being created**

- **The numbers of persons using any licensed external area at any one time**
- **The hours of operation of any licensed external area, requiring patrons to return back into the premises at a specific time. In residential areas it is suggested that a closing time of 22.00 is appropriate. Any music relayed into the external area should cease earlier**
- **The numbers of 'smokers' allowed outside of the premises at any one time**
- **The times within which live music and / or amplified sound may be played in any external area or marquees or relayed by external speakers (where permitted under the terms of the licence). It is suggested that this should not continue beyond 22.00**
- **The reduction of music levels within the premises 30 minutes before closing**
- **Keeping doors and windows closed during performances of licensable regulated entertainment**
- **Management control of entrance / exit lobbies so as to ensure that the integrity of the premises is maintained and internal sound contained**
- **Management and recording of periodic perimeter checks**
- **The provision of acoustic double door lobbies of an adequate residence time**
- **The provision of acoustic seals and self closers on doors**

- The connection of fire doors and / or private external doors to the sound limiting device (so that volume is reduced if the doors are opened)
- The installation and use of a sound-limiting device for all amplified sound to enable maximum volume and bass to be set at levels appropriate for the premises/ event
- The installation and / or maintenance of double glazing / sound resistant glass;
- The provision of sound insulation to party walls, floor and ceiling
- The provision of acoustic baffling to any ventilation extract and intake system
- The provision of additional air conditioning / air cooling to enable doors and windows to remain closed during any entertainment."

The Matizz Bar and Lounge has been wholly inadequate when it comes to meeting the council's expectations and the above represents an extensive list of failures. I concede that there seems to be some sort of self-closing device attached to the doors which are always open regardless and that there is insulation on the walls, but not the floors or ceiling.

I am therefore formally requesting that far from extending opening hours, the entertainments license should be withdrawn. Mr Gocen could then reapply provided he can prove that he has made genuine, accountable efforts to contain the noise and is not simply talking and saying the things that he knows you would like to hear.

May I remind you that the Matizz is surrounded by residents with children at 85 Mayes Road (right next door to it), by people with mental health issues from 108-114 Mayes Road and by elderly and fragile people in John Aidis House in Coburg Road. These people need your protection as they are vulnerable and cannot speak up or even write for themselves. Over 60 people objected to the original application and yet still an entertainments license was given and hence the noise problems. I was deeply disappointed at the time not to have been informed about the decision following the meeting on 4/5/17. I understand that I should have been notified within 5 days of the decision being made. Is it possible for you to send me a copy of any writings that relate to this decision and the reasons behind it and whether any conditions were attached? Also, will this latest application be looked at by a sub committee in the Civic Centre as before? If so, I would like to attend.

Finally, can you please acknowledge that you have received this letter.

I look forward to hearing from you,

Yours Sincerely,

**Anderson Chanel**

---

**From:**  
**Sent:** 02 September 2017 16:29  
**To:** Licensing  
**Subject:** Ref Matizz Bar and Lounge application for extension to its opening hours

For the attention of the licensing team

My name is \_\_\_\_\_ and I live at \_\_\_\_\_

I am writing to advise you of my objection to the application for the extension of opening hours for the Matizz Bar and Lounge

I am an elderly person that lives alone. My bedroom is opposite the pub and if permission is granted the noise levels that will be going on throughout the night will have a huge impact on my nights sleep.

I am concerned that if the pub remains open for extended hours there will be an increased amount of disturbance in the area which could also impact on the safety of the area. Also I am concerned about property damage from people who may be more intoxicated and drinking for longer hours.

The pub is surrounded by houses and is not in an area where late licenses and extended opening hours are appropriate. There are many people living nearby, elderly and families with children.

I hope that you take my points on board when making your decision as I really do not feel that granting permission would be of benefit to the community.

Kind regards



~~Wood Green~~  
Wood Green N22  
London

~~03-09-17~~  
03-09-17

Dear Sir/Madam,

This is just a reminder of our last letter to your Committee concerning the Owner of the Maltby Bar.

We in this neighbourhood are affected greatly by the noise and unruly behaviour especially in the late hours and closing time I am on medication and some others that we know of.

We in this neighbourhood feel it is a grave mistake to give them a three o'clock extension this is a residential neighbourhood for a night club and we ask for this to be considered carefully.

Thank you very much,  
Yours Sincerely,

Woodgreen n22

4.9.17.

To Whome it may concern.

Dear Sir or Madam.

I understand that the Pub  
Naligz bar wanted a time extension,  
I am not happy about that. The reason  
is, the people that goes to the pub, is  
uncontrollable. On their way out they make a lot  
of noise, playing loud music, blowing car horns,  
eve fighting and swearing, and this will  
continue until late in the morning.

I got lots of headach and lack of sleep  
from that. Therefore I do not want them  
to open late.

yours truly

## **Shah Noshaba**

---

**From:** >  
**Sent:** 05 September 2017 16:13  
**To:** Licensing  
**Subject:** LICENSING ACT 2003 - REPRESENTATION FORM - Matlzz Bar and Lounge, 63 Mayes Road, Wood Green, London, N22 6UP

Dear Sir or Madam,

I ( ) am making a representation regarding the granting of a late licence to Matlzz Bar and Lounge, 83 Mayes Road, Wood Green, London, N22 6UP.

I am making a representation under the category, "The Prevention of Public Nuisance", namely:

This is situated in a residential area that is quiet after about 9 or 10 O'clock in the evening and allowing this extension will lead to a totally unacceptable rise in noise levels and disturbance to the residents in the immediate vicinity in the early hours of the morning when they require peace and rest for the following day.

Previously an establishment here was open until these times and it was a total disaster with loud thumping music and police regularly called to deal with disturbances at "chucking out" time.

Since this bar re-opened a few months ago there have been frequent noise violations as well as disturbances requiring police and ambulance attendance, including police doing a door to door on a Sunday morning gathering evidence from a serious disturbance. This has happened when the pub only opens normal hours and an extension to this is likely to lead to intolerable nuisance and disturbance.

If you require further info from me then please let me know.

Yours Sincerely,

**Appendix 4- Copy of current licence**

## PREMISES LICENCE

Receipt: AG762941

Premises Licence Number: LN/00001646  
LN/000003309

*This Premises Licence has been issued by:*

**The Licensing Authority, London Borough of Haringey,  
6<sup>th</sup> Floor Alexandra House, 10 Station Road,  
Wood Green, London, N22 7TR**

Signature: .....

Date: 24<sup>th</sup> November 2005  
Transfer & Vary DPS: 2<sup>nd</sup> June 2017

### Part 1 – PREMISES DETAILS

**Postal Address of Premises or, if none, Ordnance Survey map reference or description:**

**MATIZZ BAR & LOUNGE  
83 MAYES ROAD  
WOOD GREEN  
LONDON N22 6UP**

Telephone:

**Where the Licence is time limited, the dates:**

Not applicable

**Licensable activities authorised by the Licence:**

**Supply of Alcohol**

**Regulated Entertainment: Live Music & Recorded Music**

**Provision of Late Night Refreshment**

**The times the Licence authorises the carrying out of licensable activities:**

**Supply of Alcohol**

**Monday to Sunday                      1000 to 2330**

**Live Music and Recorded Music**

**Monday to Sunday                      1000 to 2330**

**Provision of Late Night Refreshment**

**Monday to Sunday                      2300 to 2330**

**The opening hours of the premises:**

**Monday to Sunday                      1000 to 0000**

**New Years Eve opening hours from the start of permitted hours on 31 December until the start of permitted hours on 1 January.**

LICENSING ACT 2003  
Sec 24

The outside shisha area is to close and all customers are to be asked to come inside by 2230, Monday to Sunday.

**Where the Licence authorises supplies of alcohol whether these are on and/or off supplies:**

Supply of alcohol for consumption both ON and OFF the premises

**Part 2**

**Name, (registered) address, telephone number and e-mail (where relevant) of holder of Premises Licence:**

Anil Gocen  
7 Aubert Court  
Avenell Road  
London  
N5 1BJ

**Registered number of holder, for example company number, charity number (where applicable):**

Not applicable

**Name, address and telephone number of designated premises supervisor where the Premises Licence authorises the supply of alcohol:**

Funda Yenidogan  
23 Hickory Close  
Edmonton  
London  
N9 7PY

**Personal Licence number and issuing authority of personal licence held by designated premises supervisor where the Premises Licence authorises for the supply of alcohol:**

Personal Licence: LN/201500331

Issued by: London Borough of Enfield

## **Annex 1 –Mandatory Conditions**

1. No supply of alcohol may be made under the Premises Licence –
  - (a) At a time when there is no Designated Premises Supervisor in respect of the Premises Licence; or
  - (b) At a time when the Designated Premises Supervisor does not hold a Personal Licence or his Personal Licence is suspended.
2. Every supply of alcohol under the Premises Licence must be made, or authorised by a person who holds a Personal Licence.
3.
  - (1) The responsible person must ensure that staff on relevant premises do not carry out, arrange or participate in any irresponsible promotions in relation to the premises.
  - (2) In this paragraph, an irresponsible promotion means any one or more of the following activities, or substantially similar activities, carried on for the purpose of encouraging the sale or supply of alcohol for consumption on the premises.
    - a) games or other activities which require or encourage, or are designed to require or encourage, individuals to –
      - (i) drink a quantity of alcohol within a time limit (other than to drink alcohol sold or supplied on the premises before the cessation of the period in which the responsible person is authorised to sell or supply alcohol), or
      - (ii) drink as much alcohol as possible (whether within a time limit or otherwise);
    - b) provision of unlimited or unspecified quantities of alcohol free or for a fixed or discounted fee to the public or to a group defined by a particular characteristic in a manner which carries a significant risk of undermining a licensing objective;
    - c) provision of free or discounted alcohol or any other thing as a prize to encourage or reward the purchase and consumption of alcohol over a period of 24 hours or less in a manner which carries a significant risk of undermining a licensing objective;
    - d) selling or supplying alcohol in association with promotional posters or flyers on, or in the vicinity of, the premises which can reasonably be considered to condone, encourage or glamorise anti-social behaviour or to refer to the effects of drunkenness in any favourable manner.
    - e) dispensing alcohol directly by one person into the mouth of another (other than where that other person is unable to drink without assistance by reason of disability).
4. The responsible person must ensure that free potable water is provided on request to customers where it is reasonably available.
5.
  - (1) The premises licence holder or club premises certificate holder must ensure that an age verification policy is adopted in respect of the premises in relation to the sale or supply of alcohol.
  - (2) The designated premises supervisor in relation to the premises licences must ensure that the supply of alcohol at the premises is carried on in accordance with the age verification policy.

## **Annex 1 –Mandatory Conditions**

(3) The policy must require individuals who appear to the responsible person to be under 18 years of age (or such older age as may be specified in the policy) to produce on request, before being served alcohol, identification bearing their photograph, date of birth and either:-

- (a) a holographic mark or
- (b) an ultraviolet feature.

6. The responsible person shall ensure that –

- (a) where any of the following alcoholic drinks is sold or supplied for consumption on the premises (other than alcoholic drinks sold or supplied having been made up in advance ready for sale or supply in a securely closed container) it is available to customers in the following measures –
  - (i) beer or cider: ½ pint;
  - (ii) gin, rum, vodka or whisky: 25 ml or 35 ml; and
  - (iii) still wine in a glass: 125 ml; and
- (b) these measures are displayed in a menu, price list or other printed material which is available to customers on the premises; and
- (c) where a customer does not in relation to a sale of alcohol specify the quantity of alcohol to be sold, the customer is made aware that these measures are available.

### **Minimum Drinks Pricing**

1. A relevant person shall ensure that no alcohol is sold or supplied for consumption on or off the premises for a price which is less than the permitted price.

2. For the purposes of the condition set out in paragraph 1 –

(a) "duty" is to be construed in accordance with the Alcoholic Liquor Duties Act 1979

(b) "permitted price" is the price found by applying the formula –

$$P = D + (D \times V)$$

Where –

- (i) P is the permitted price
  - (ii) D is the amount of duty chargeable in relation to the alcohol as if the duty were charged on the date of the sale or supply of the alcohol, and
  - (iii) V is the rate of value added tax chargeable in relation to the alcohol as if the value added tax were charged on the date of the sale or supply of the alcohol;
- (c) "relevant person" means, in relation to premises in respect of which there is in force a premises licence –
- (i) The holder of the premises licence
  - (ii) The designated premises supervisor (if any) in respect of such a licence, or
  - (iii) The personal licence holder who makes or authorises a supply of alcohol under such a licence;



## **Annex 1 –Mandatory Conditions**

(d) "relevant person" means, in relation to premises in respect of which there is in force a club premises certificate, any member or officer of the club present on the premises in a capacity which enables the member or officer to prevent the supply in question; and

(e) "value added tax" means value added tax charged in accordance with the Value Added Tax Act 1994.

3. Where the permitted price given by Paragraph (b) of paragraph 2 would (apart from the paragraph) not be a whole number of pennies, the price given by that sub-paragraph shall be taken to be the price actually given by that sub-paragraph rounded up to the nearest penny.
4. (1) Sub-paragraph (2) applies where the permitted price given by Paragraph (b) of paragraph 2 on a day ("the first day") would be different from the permitted price on the next day ("the second day") as a result of a change to the rate of duty or value added tax.  
  
(2) The permitted price which would apply on the first day applies to sales or supplies of alcohol which take place before the expiry of the period of 14 days beginning on the second day.

### **Door supervisor:**

All individual(s) at the premises for the purpose of carrying out a security activity must

- (a) be authorised to carry out that activity by a licence granted under the Private Security Industry Act 2001; or
- (b) be entitled to carry out that activity by virtue of section 4 of that Act.

## **Annex 2 – Conditions consistent with the Operating Schedule**

### **THE PREVENTION OF CRIME AND DISORDER**

On Friday and Saturday nights a minimum of two door supervisors approved by the security industry authority will be employed on the premises to control the entry and exit of customers.

All exterior areas will be illuminated.

All toilets will be checked regularly.

The licensee and staff will monitor customer behaviour especially during busy periods.

Drug prevention methods will be employed and the relevant signage displayed

Premises will have a drivers' shelf with a selection of soft drinks.

Premises will be a member of Pubwatch.

Premises will display drink drive posters on site.

### **PUBLIC SAFETY**

Premises will have a first aid box available for staff and customers.

The pub will promote a licensed taxi service to facilitate its customers making onwards journeys.

An accident/incident book will be on site for staff and public.

Premises will provide assistance to the disabled when required.

Fire fighting equipment will be serviced regularly.

Pest control contract will be in place.

There shall always be current electric and gas certificates in place.

### **THE PREVENTION OF PUBLIC NUISANCE**

Premises will have no opening windows in the bar area.

A regular noise survey will be carried out.

When required staff will organise taxis to transport customers home and customers will be seen off premises and encouraged to disperse at closing.

Cellar cooling condenser will be in a position so as not to cause a noise nuisance.

"Please respect our neighbours and leave quietly" sign will be on display.

The fabric of the building will be sound retaining.

### **Prevention of nuisance from noise/vibration**

All doors and windows will remain closed, except for access to or egress from the premises, during the licensed regulated entertainment activities or in any event after 11pm. The entrance door will be fitted with a self-closing device and staff required to ensure that it is not propped open. A member of staff shall be made responsible to ensure the door is opened for as brief a period as possible. Where necessary adequate and suitable mechanical ventilation will be provided to public areas.

Entry to the premises will be restricted to front main entrance located on Mayes Road whilst the premises is being used for regulated entertainment licensed activity.

## **Annex 2 – Conditions consistent with the Operating Schedule**

Entrance/exit from the premises whilst regulated entertainment licensable activities are ongoing shall be via a lobbied door to minimise noise breakout.

### **Sound limits**

The licensee shall ensure that no music played in the licensed premises is audible at or within the site boundary of any residential property.

All regulated entertainment amplified activity will utilise the in-house amplification system, the maximum output of which is controlled by the duty manager.

### **Outside Areas**

No regulated entertainment will be played in, or for the benefit of patrons in external areas of the premises.

Signs shall be displayed in the rear beer garden requesting patrons to recognise the residential nature of the area and conduct their behaviour accordingly. The management must reserve the right to ask patrons to move inside the premises or leave if it is felt that they could be disturbing neighbours.

The outside shisha area is to close and all customers are to be asked to come inside by 2230, Monday to Sunday.

### **Deliveries and collections**

Deliveries and wherever possible collections associated with the premises will be arranged between the hours 0800 to 1900 Mondays to Saturdays and not on Sundays or Bank Holidays so as to minimise the disturbance caused to the neighbours.

Glasses will be collected from the external area at the beginning of the day rather than at closing time when neighbours in close proximity might be unduly disturbed.

Empty bottles and non-degradable refuse will remain in the premises at the end of trading hours and taken out to the refuse point at the start of the working day rather than at the end of trading when neighbours might be unduly disturbed.

### **Plant and machinery**

All plant and machinery is correctly maintained and regularly serviced to ensure that it is operating efficiently and with minimal disturbance to neighbours arising from noise.

### **Dealing with complaints**

Liaison meetings will be held where specifically requested by residents to enable neighbours to raise concerns about any aspect of the licensed activities.

### **Patrons entering/exiting the premises**

A minimum of 2 door supervisors will be used on a Friday and Saturday evening (or on any other days that premises is open beyond it's regular hours as stipulated on the premises licence) from 21:00h until the premises closes. One will be positioned at front on main door and one will be positioned in rear beer garden.

When being used at closing time a door supervisor shall monitor patrons to ensure they leave in a prompt and courteous manner and are respecting the neighbours.

When being used at closing time a door supervisor will be positioned on the exit door to ensure, as far as reasonably practical, that patrons do not leave with open vessels.

Any drinks purchased for consumption off the premises must be in sealed containers.

## **Annex 2 – Conditions consistent with the Operating Schedule**

### **Prevention of nuisance from odour**

All ventilation and extraction systems shall be correctly maintained and regularly serviced to ensure that it is operating efficiently and with minimal disturbance to neighbours arising from odour.

### **THE PROTECTION OF CHILDREN**

Premises will not allow unaccompanied children at any time.

No children will be permitted on the premises after 20:00 hours.

AWP will be positioned in site of the bar counter.

Suitable soft drinks menu will always be available.

Alcohol may only be sold to individuals over the age of 18 with valid proof of identification with one of the following:

- A valid passport
- A photo driving license issued in a European Union Country
- A proof of age standard card system
- A citizen card, supported by the Home Office

### **Annex 3 – Conditions attached after a hearing by the licensing authority**

#### **Review-16<sup>th</sup> December 2016**

The Committee decided to modify the conditions of the licence as follows:

The conditions proposed by the Police at pages 84 and 86 of the agenda pack are to be imposed.

**Opening hours:**

Monday to Sunday            1000 to 0000

**Supply of alcohol:**

Monday to Sunday            1000 to 2330

**Live music and recorded music:**

Monday to Sunday            1000 to 2330

**Provision of late night refreshment:**

Monday to Sunday            2300 to 2330

The outside shisha area is to close and all customers are to be asked to come inside by 2230, Monday to Sunday.

The Committee confirmed that no licensable activities, including the supply of alcohol, are to be carried out in the shisha area, as this does not form part of the area covered by the current licence.

The Committee took into consideration the record of incidents relating to public nuisance and crime and disorder as submitted by local residents, the Council's Noise Enforcement team and the Police. The committee was satisfied that despite having had a number of opportunities to address the public nuisance and crime and disorder that were emanating from the premises, the management of the premises had failed to take adequate steps to address the behaviour concerned. The evidence put forward regarding the incidents by the applicant and his representative was credible and reflected long standing matters of concern to residents. It was also clear that the impact and potential harm to local residents, many of whom are vulnerable by reason of age could not be ignored. Having heard evidence from the respondent regarding recent changes to the management of the premises, the committee took the view that the measures imposed were an appropriate and proportionate response to promote the four Licensing Objectives.

The committee only made its decision after having heard all the evidence of the parties and considered its decision to be proportionate.

#### **Informative**

The Committee recommended that the DPS undertake training in relation to their responsibilities under the Licensing Act 2003 on a regular basis and that, in the event that Mr Hussain replace the current DPS on the premises licence as indicated at the hearing, he also undertake to complete such training on a regular basis.

**Annex 4 - Plans**

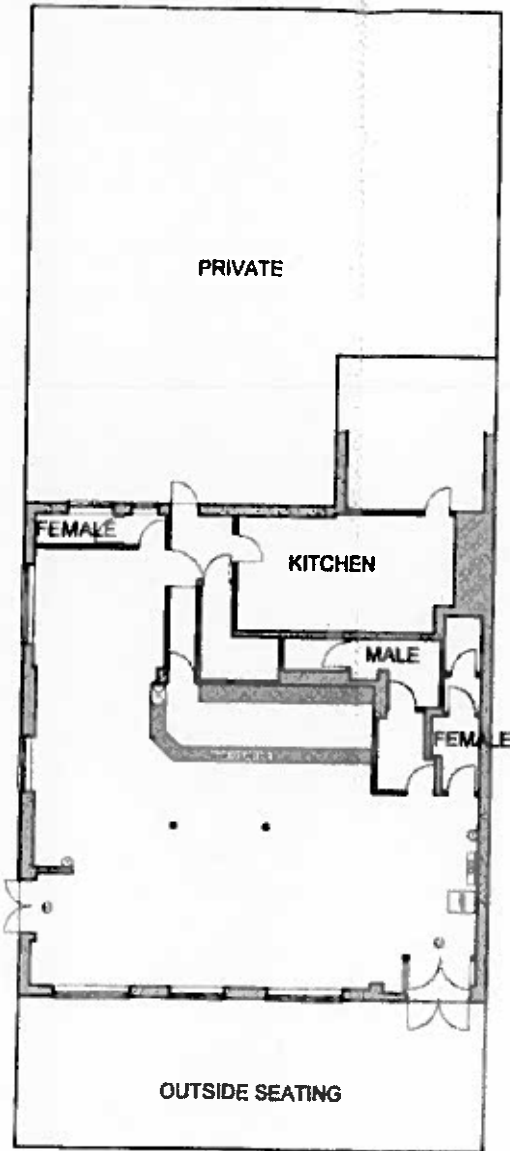

EXISTING GROUND FLOOR PLAN



LOCATION PLAN,  
SCALE 1:500

**KEY**

- (SD) SMOKE DETECTOR
- (W) 9 LITRE WATER EXTINGUISHER
- (F) FOAM EXTINGUISHER
- (P) DRY POWDER EXTINGUISHER
- (C) CO2 EXTINGUISHER
- (C) WET CHEMICAL EXTINGUISHER
- (E) ILLUMINATED 'EXIT' SIGN
- (E) ILLUMINATED 'EMERGENCY EXIT' SIGN
- (E) ILLUMINATED 'EXIT' SIGN WITH DIRECTIONAL ARROW
- (CIG) CIGARETTE VENDING MACHINE
- (AWP) FRUIT MACHINE

REV	DATE	DETAILS	DRAWN
 <b>ROMANS</b> Surveyors			
4 KING STREET LANE, WINDERSH, BERKSHIRE, RG41 5AA TELEPHONE: 0118 536 6600			
23 THE AVENUE, SOUTHAMPTON, HAMPSHIRE, SO17 1BA TELEPHONE: 0330 460110			
84 BRAY ROAD, THAMESHAM, WINDERSH, RG1 2AA TELEPHONE: 0330 630000			
E-MAIL: ROMANS@ROMANS.CO.UK WWW. ROMANS.CO.UK			
IN REPLY TO <b>PUNCH TAVERNS plc</b>			
PROJECT TITLE <b>Duke of Edinburgh, 83 Mayes Road, Wood Green, N22 6UP.</b>			
DRAWING TITLE		SCALE	
Existing Floor Plans		1:100	
DRAWN		DATE	
TINU OJO		27.08.04	
CHECKED		DATE TEL	
		08/72 001 A	
ROMANS SURVEYORS ARE PART OF THE ROMANS GROUP HOLDINGS.			
COMMERCIAL LAND & NEW HOMES	SURVEYORS	AGRICULTURAL FLOORS ITA	<b>The ROMANS GROUP</b>
LETTINGS	RESIDENTIAL	DEVELOPERS	
<b>OUTLET NO</b>			